

PURE STEAM PIPE ROUTING - (SERVICE FLOOR)

27/07/2023

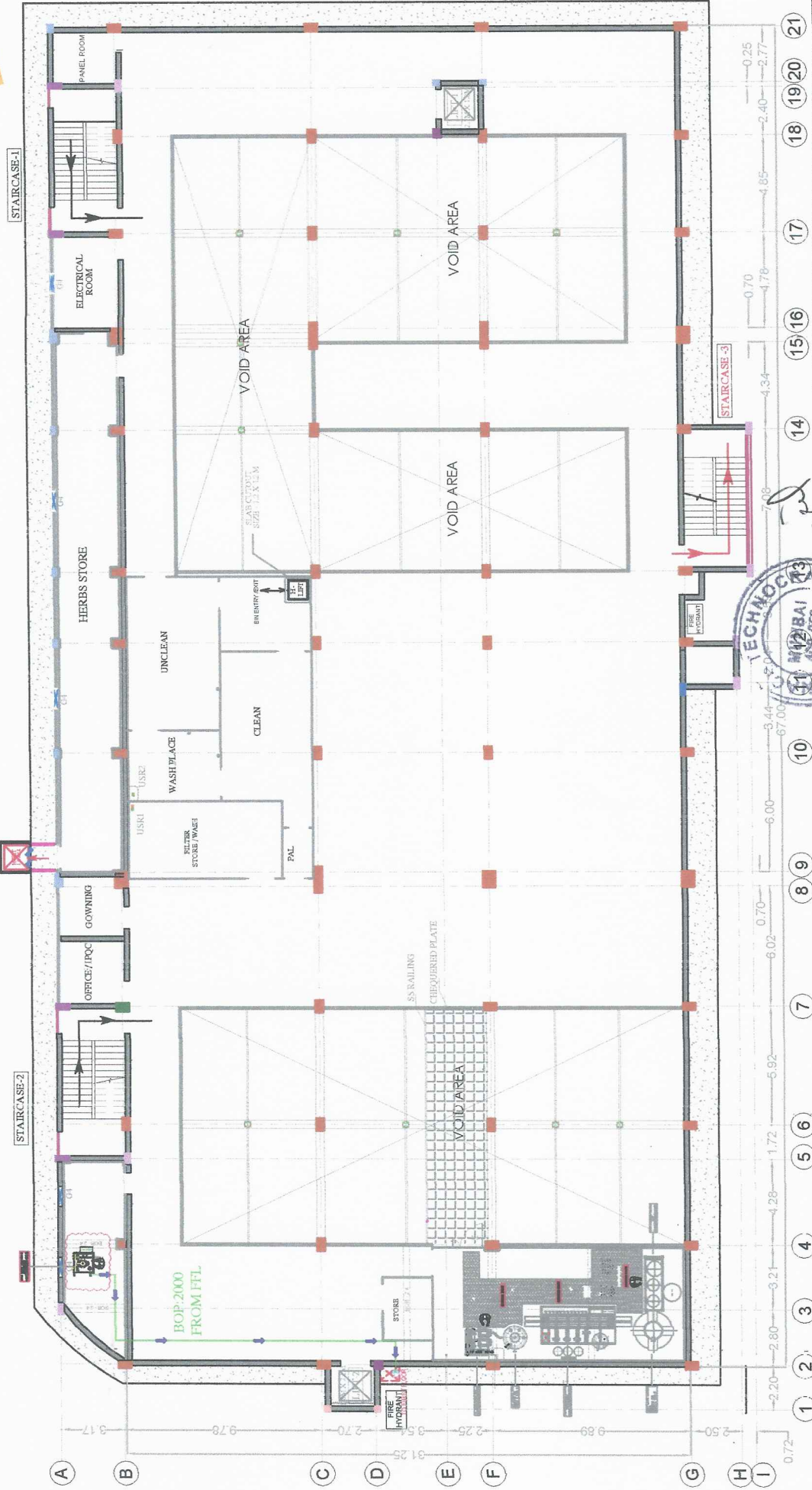

LEGENDS:

- ϕ 1.0" HEADER LINE - PURE STEAM PIPE ROUTE
- MOC : SS 316 L
- HEADER LINE - ϕ 1.0" PIPE
- BOP (BOTTOM OF PIPE) - 2.0M FROM FFL

HEIGHT DETAILS FROM FFL:

- BOTTOM OF SLAB : 2.7M
- BOTTOM OF BEAM : 2.1M
- FALSE CEILING HEIGHT : 2.6M

TYPICAL SECTION

N

HOMCO.	
CONSULTANT-KNACK TECHNOCRATS	
42 AWASH, J.P. ROAD, ANDHERI (W), MUMBAI - 400 053	
TEL: 91 22 26314010, 26361629	
EMAIL: info@knacktechnocrats.com	
DRAWN BY ABID H	DATE 27-07-2023
CHECKED BY I ANSAR	SCALE AS SHOWN
ALL DIMENSIONS ARE IN METERS UNLESS OTHERWISE SPECIFIED.	
TITLE PURE STEAM PIPE ROUTING - (SERVICE FLOOR)	
DWG. NO. 27/07/2023	
REVISION -	
FILE Z:\Homco\2023\PC-Details\Sp. 13-09-2023\Pipe route\PURE STEAM PIPE ROUTING - SF.dwg	

NOTE: PIPE ROUT IS ONLY INDICATIVE, IT MAY VARY AS PER SITE FEASIBILITY.